

Platform Cable Glands

Nickel Plated Brass Glands and Locknuts with Neoprene Rubber Compression Inserts



PG Glands

Type	Thread Size	Clearance Dia.	Thread Length	Capacity Wide	Capacity Thick
12.1616	PG 16.0	23mm	6.5mm	5-16mm	2-5mm
12.2121	PG 21.0	28mm	7mm	9-21mm	3-8mm
12.2930	PG 29.0	37mm	8mm	14-30mm	4-11mm
12.3640	PG 36.0	47mm	9mm	24-40mm	4-11mm
12.3642	PG 36.0	47mm	9mm	42mm	6mm
12.4245	PG 42.0	53mm	10mm	29-45mm	5-12mm
12.4250	PG 42.0	53mm	10mm	50mm	6mm
18.3642 (Nylon)	PG 36.0	47mm	10mm	42mm	6mm



Nickel plated brass glands

Metric Glands

Type	Thread Size	Clearance Dia.	Thread Length	Capacity Wide	Capacity Thick
M20/16	M20	22mm	6.5mm	1-15mm	1-5mm
M25/21	M25	28mm	7mm	9-20mm	3-8mm
M32/29	M32	35mm	8mm	14-27mm	4-11.5mm
M40/36	M40	43mm	9mm	24-34mm	4-11.5mm
M50/42	M50	53mm	9mm	29-44mm	5-12mm
M63/48	M63	66mm	10mm	34-59mm	5-12mm



Neoprene rubber compression inserts

Diecast Aluminium Cable Gland Plates

Type	A	B	C	D	E	F	G	Capacity Wide	Capacity Thick
8107	103mm	28mm	44mm	32mm	16mm	89mm	60mm	46-56mm	6-15mm
8108	127mm	32mm	56mm	42mm	25mm	110mm	79mm	60-75mm	8-22mm
8110	165mm	32mm	75mm	58mm	40mm	146mm	94mm	60-75-93mm	8-22-39mm

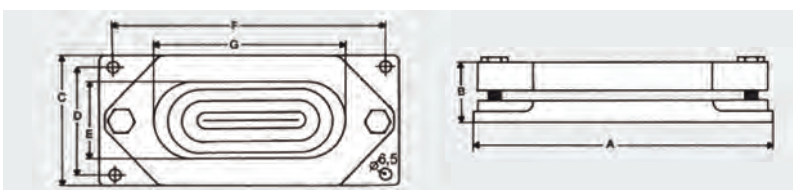

Platform Cable Glands

Nickel Plated Brass Glands and Locknuts with Neoprene Rubber Compression Inserts

Polyethylene Flute Glands (all PG sizes are stock items)

Type PG21 Flute Gland

Thread	Ref.	Min. cable size	Max. cable size
PG21	82-0	19 x 7mm	22 x 9mm
PG21	83-9	26 x 8mm	29 x 10mm
PG21	85-5	27 x 4mm	30 x 6mm
PG21	80-4	36 x 7mm	39 x 9mm
PG21	92-8	37 x 11mm	40 x 14mm



Type PG16 Flute Gland

Thread	Min. cable size	Max. cable size
PG16	17 x 6mm	19 x 8mm



Reducers

Ext. Thread	Int. Thread	Reference
PG29	PG21	44-2
PG29	PG16	79-9
PG21	PG16	41-8
PG21	PG13.5	-

Enlargers

Ext. Thread	Int. Thread	Reference
PG16	PG21	97-7

All Polyethylene Glands are supplied c/w Nylon Washer & Locknut